

Figure A

**Procedures for adjusting Drive Belt tension on the ProTrac-200-2**

Tools Required for this job are as follows:  
 2.5 mm Allen hex wrench, 4 mm Allen hex wrench, 5 mm Allen hex wrench

**To adjust the drive belt on the motor side**

1. Find the end plate with the adjustment screw as noted in Figure A (Item 1). Do all tension adjustments from this end.
2. Remove the two screws (2.5 mm wrench) from the back of the encoder cover (Figure B Item 1).
3. Slide the cover away to the side (BE CAREFUL NOT TO DAMAGE THE WIRES).
4. Remove the six screws (4 mm wrench) from the drive housing cover (Figure B Item 2).
5. Lift the cover slightly (to clear the stop spacer). Align the large slot in the plate to the wires coming out of the encoder and slide the cover away to the side with the encoder cover. (CAREFUL NOT TO STRAIN THE WIRES OR BUMP THE ENCODER).
6. Loosen (no more than 1/2 turn) the four screws (Figure C Item 1) (5 mm wrench) holding the drive housing to the track.
7. Slide drive housing towards end of track to tighten belt.
8. Tighten the four screws.
9. Replace the gear housing cover (Align the stop spacer with the small slot in the cover) (Figure D).
10. Replace the encoder cover (taking care not to pinch the wires).

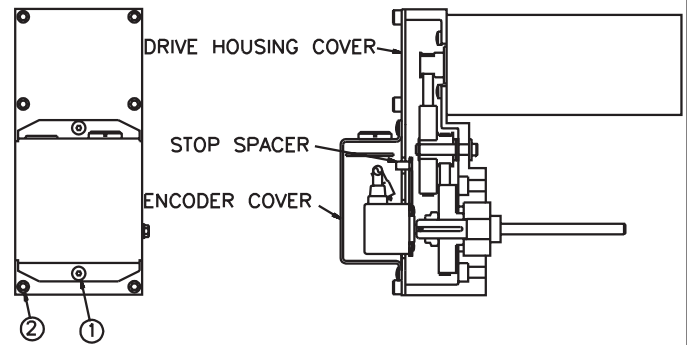

Figure B

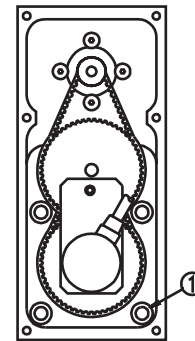

Figure C

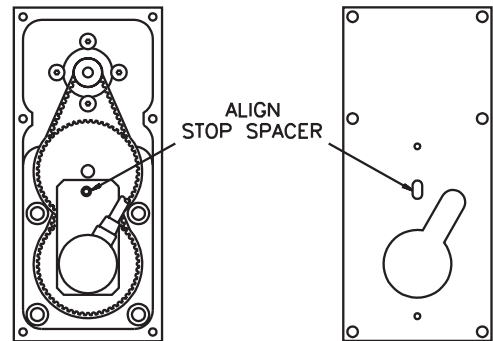

Figure D

**To adjust the drive belt on the opposite side**

1. Tighten (clockwise) the bolt (4 mm wrench) on the end of the track (Figure A, Item 1) to tighten the belt.