

FIFE SYMAT 50 OFFSET PIVOT GUIDE

MAXCESS

MAGPOWR



TIDLAND



Durable and versatile, the Symat 50 electromechanical offset pivot guide is engineered to accommodate web widths up to 533 mm (21 inches) wide and tensions up to 623 N (140 lbf). This guide is ideal for edge, line, or center guiding applications where short entry and exit spans are required.

Built for long-lasting, reliable operation, the Symat 50 delivers fast response for highly accurate web positioning. This guide is available with standard roller faces of 203 mm to 610 mm (8 inches to 24 inches). Optional Servo-Center provides automatic guide centering to speed the setup and threading process.

GENERAL SPECIFICATIONS

Product Name

Symat 50 Offset Pivot Guide

Guide Span

254 mm to 610 mm (10 inches to 24 inches)

Roller Face

203 mm to 610 mm (8 inches to 24 inches)

Roller Diameter

57 mm to 152 mm (2.25 inches to 6.0 inches)

Maximum Correction

31 mm (± 1.824 inch)

Load Capacity

Up to 623 N (140 lbf)

KEY FEATURES

- Fast, accurate web positioning for web widths up to 533 mm (21 inches)
- Precise, backlash-free actuator and DC Servomotor
- Durable construction for low maintenance and long-lasting reliability
- Accommodates all threading styles
- Optional Servo-Center available to speed setup and threading
- All standard Fife sensors and controllers can be used for edge, center, or line guiding
- Optional mounting brackets and stands are available
- Custom designs are available upon request

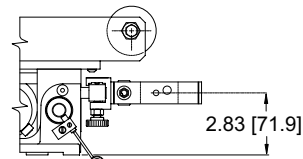
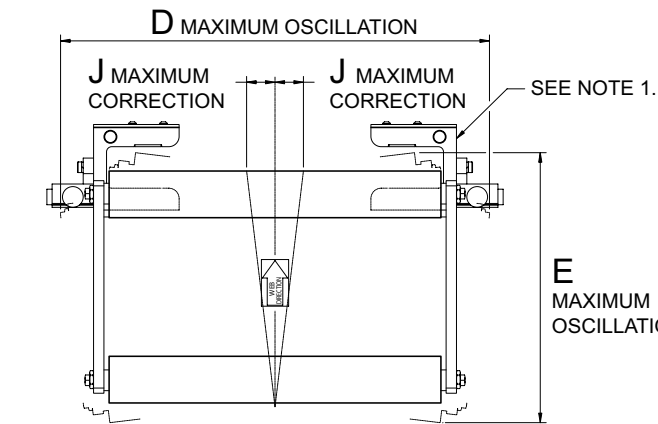

ALTERNATE SENSOR MOUNTING
SEE NOTE 2.

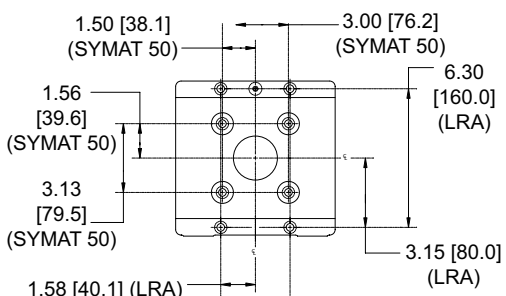

ALTERNATE BOLT HOLE PATTERNS
SEE NOTE 6.

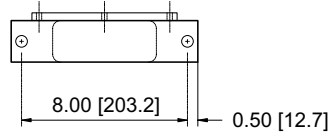
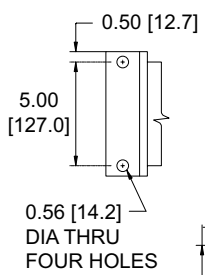
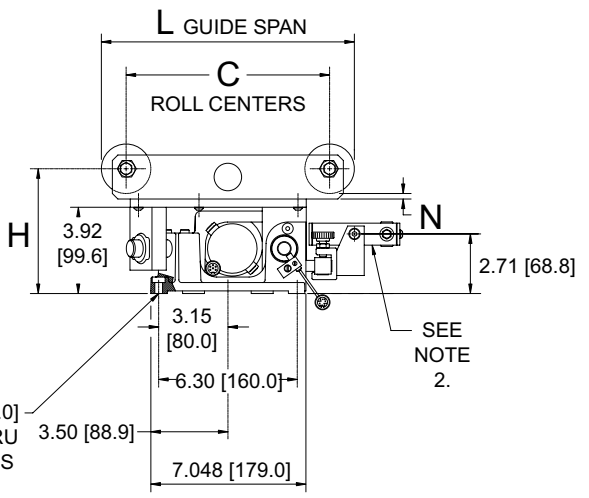
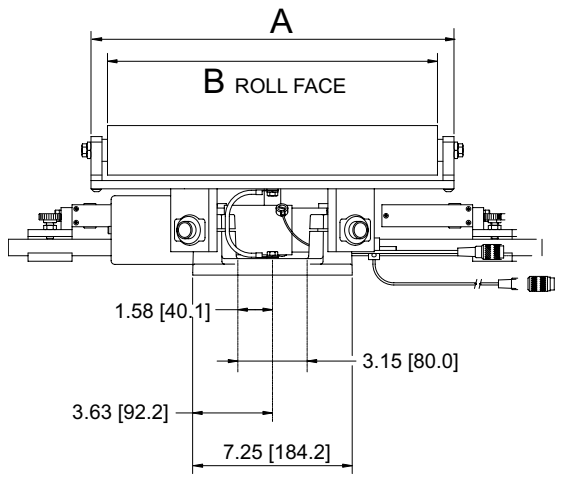

0.354 [9.0]
DIA THRU
4 HOLES

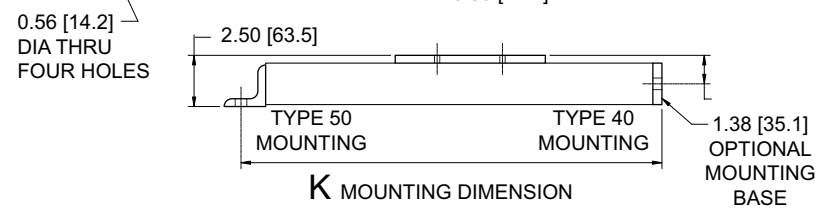

NOTES:

1. Guides are available with one or two sensors
2. If guide L is less than 286 mm (11.25 inches), sensor mounting on guide base is not available
3. Refer to Tables A and B on the next page for dimension specifications
4. A Wrap Style Diagram is provided on the last page of this product sheet
5. All dimensions shown in parenthesis are in millimeters
6. Alternate bolt hole patterns for LRA-OPG or Symat 50

FIGURE 1 SYMAT 50 MODEL SPECIFICATIONS

AVAILABLE ROLL FACE, B:	203 mm (8 inches) maximum 610 mm (24 inches) maximum
L DIMENSIONS AVAILABLE FOR WRAP STYLES 2,3,5,8,10,11,14,16	24 mm (9.5 inches) minimum 610 mm (24 inches) maximum
L DIMENSIONS AVAILABLE 1,4,6,7,9,12,13,15	254 mm (10 inches) maximum 610 mm (24 inches) maximum
AVAILABLE ROLL DIAMETERS	57, 76, 102, 127, and 152 mm (2.25, 3, 4, 5, and 6 inches)
APPROXIMATE MAXIMUM CORRECTION	$L/70 + 0.9$ inches
MAXIMUM WEB TENSION	Wrap Styles: 1, 5, 6, 9, 10, 13, and 14 = 623 N (140 lbf) Wrap Styles: 3, 4, 7, 8, 11, 12, 15, and 16 = 311 N (70 lbf)
ACTUATOR TYPE	Electromechanical Stroke: 13, 25 and 40 mm (0.5, 1, and 1.57 inches) Thrust: 155 N (33 lbf)
GUIDE/ACTUATOR RATIO	Total Correction / Actuator Stroke is approximately: $L/50 + 1.2$ inches
CORRECTION SPEED	Actuator Speed x Guide/Actuator Speed
MAXIMUM OPERATING TEMPERATURE	For standard guides: 52° C (125° F)

FIGURE 2 SYMAT 50 MODEL DIMENSIONS

- A Roll face + 38 mm (1.5 inches) with the following restrictions:
 - 256 mm (10.06 inches) minimum when $L = 241$ mm to 331 mm (9.5 inches to 13.0 inches)
 - 286 mm (11.25 inches) minimum when $L = 332$ mm to 407 mm (13.1 inches to 16.0 inches)
 - 318 mm (12.50 inches) minimum when $L = 408$ mm to 483 mm (16.1 inches to 19.0 inches)
 - 349 mm (13.75 inches) minimum when $L = 484$ mm to 534 mm (19.1 inches to 21.0 inches)
 - 375 mm (14.75 inches) minimum when $L = 535$ mm to 610 mm (21.1 inches to 24.0 inches)
- B Roll face 203 mm through 610 mm (8.00 inches through 24.00 inches)
- C Roll Centers = $L - \text{Roll Diameter}$
- D Maximum Oscillation is approximately: $A + 2J + 1.00$ inch
- E Maximum Oscillation is approximately $L + A(J/L)$
- H Approximate roll height: $1/2(\text{Roll Diameter}) + N + 4.4$ inches
(Roll height will vary up to ± 0.25 inch due to variations in pivot carrier thickness)
- J Maximum correction is approximately: $L/70 + 0.9$ inch
- K Maximum mounting dimension: 1,219 mm (48 inches)
- L Guide Span: 241 mm to 610 mm (9.5 inches to 24 inches); See table for restrictions
- N 6 mm (0.25 inch) for wrap styles 1, 6, 9 and 13. 19 mm (0.75 inch) for other wrap styles

FIFE SYMAT 50 OFFSET PIVOT GUIDE

OFFSET PIVOT GUIDE WRAP STYLES

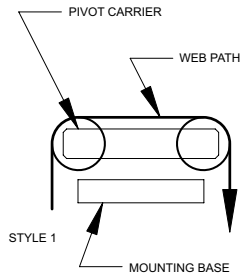

STYLE 1

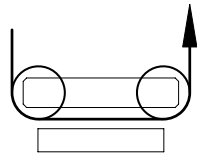

STYLE 2

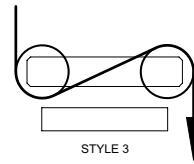

STYLE 3

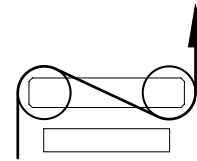

STYLE 4

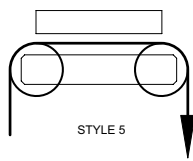

STYLE 5

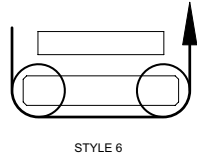

STYLE 6

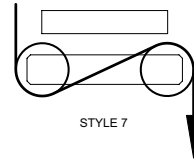

STYLE 7

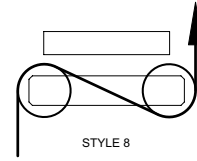

STYLE 8

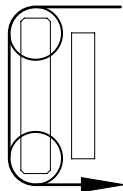

STYLE 9

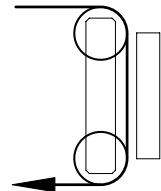

STYLE 10

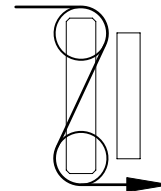

STYLE 11

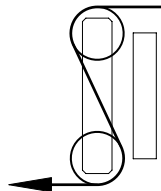

STYLE 12

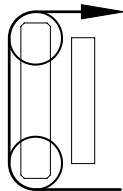

STYLE 13

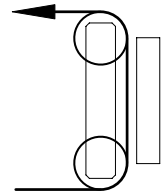

STYLE 14

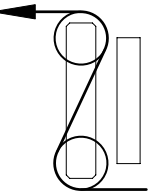

STYLE 15

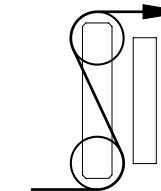

STYLE 16



MAGPOWR



TIDLAND

NORTH AMERICA

Toll Free 800.636.3433
Tel +1.405.755.1600
Fax +1.405.755.8425
sales@maxcessintl.com
www.maxcessintl.com

SOUTH AMERICA

Tel +55.11.3959.0990
Fax +55.11.3856.0990
southamerica@maxcessintl.com
www.maxcessintl.com.br

EUROPE

Tel +49.6195.7002.0
Fax +49.6195.7002.933
sales@maxcess.eu
www.maxcess.eu

INDIA

Tel +91.22.27602633
Fax +91.22.27602634
india@maxcessintl.com
www.maxcess.in

CHINA

Tel +86.756.881.9398
Fax +86.756.881.9393
info@maxcessintl.com.cn
www.maxcessintl.com.cn

JAPAN

Tel +81.43.421.1622
Fax +81.43.421.2895
japan@maxcessintl.com
www.maxcess.jp

KOREA, TAIWAN AND SE ASIA

Tel +65.9620.3883
Fax +65.6235.4818
asia@maxcessintl.com