

# DFP Dancer/Follower Arm Position Sensor



## Features

Rugged cast, non-magnetic housing

Water tight construction, heavy gasketed lid, sealed shaft and threaded conduit entrance

Easy to mount, roomy interior for wiring

Terminal block supplied. No wire nuts needed

Sturdy shaft supported on precision, sealed ball bearings

Sensor element protected from shaft loads by precision, zero backlash coupling

Electrical output vs. shaft rotation held within 1% linearity

## Specifications

Potentiometer	1 k $\Omega$ , 360° rotation
Overhung Load Capacity	54.4 kg (120 lb) at center of shaft
Enclosure	IP62
Part Number	DFP

## NOTES

1. Potentiometer output is centered when keyway is up
2. Continuous rotation is allowable
3. Overhung load capacity is 54.4 kg (120 lb)

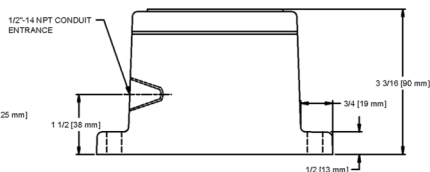
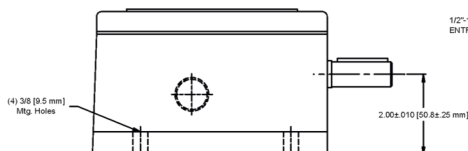
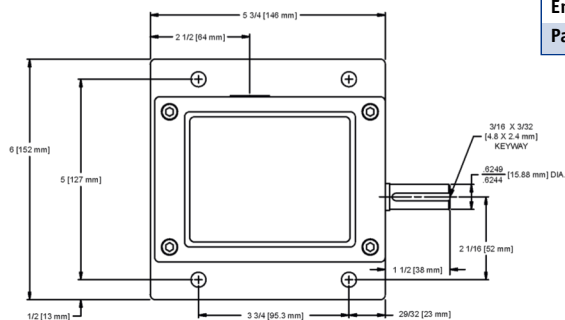

## DFP-2 Dancer/Follower Arm Position Sensor

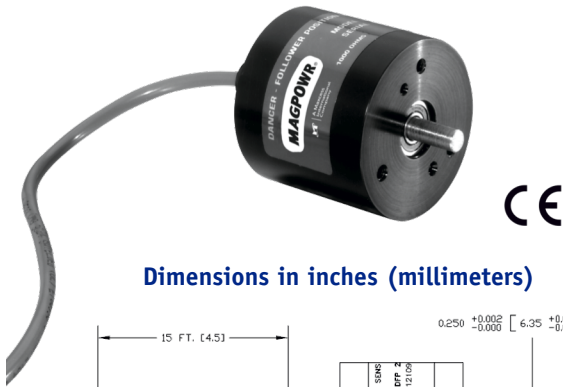

Dimensions in inches (millimeters)

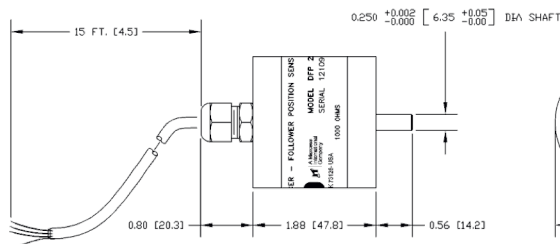

Flexible Coupling (included)

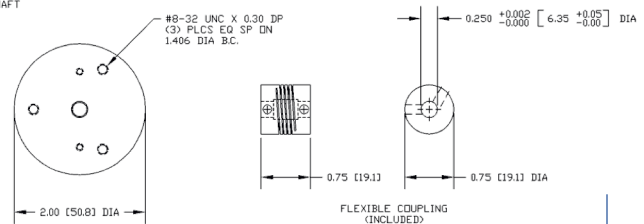

The DFP-2 position sensor is designed for use in Dancer Control applications with the VERSATEC, and in Dancer and Follower Arm applications with the Spyder, DFC-90, DFC-A and FAD. It offers the same exceptional sensing performance as the original DFP sensor, but in a lighter duty low cost housing.

A servo type flexible coupling is provided with the DFP-2 to allow for misalignment in shaft-to-shaft applications. Fifteen feet of shielded cable is also included for ease of installation.

### Features

- Compact size saves space
- High quality potentiometer element provides essentially infinite resolution
- 360° rotation prevents sensor damage
- Servo type flexible coupling accommodates installation misalignment with no backlash
- Shielded cable included for wiring convenience

### Specifications

Potentiometer	1 kΩ, 360° rotation
Shaft	Overhung load capacity, 4.5 kg (10 lb) at center of shaft
Flexible Coupling	Accommodates 5° angular and 0.25 mm (0.010 inch) offset misalignment with no backlash
Enclosure	IP62
Part Number	DFP-2