

FIFE SE-38 FIRSTEDGE SENSOR

MAXCESS

MAGPOWR



TIDLAND

The SE-38 First*Edge Sensor is an all-digital web sensor specifically designed for materials with varying opacities. Such voids, common with spun bond and loose nonwoven materials, are often difficult to detect with typical Infrared sensors, and nearly impossible to detect with air or ultrasound.

With its unique 180° foldback prism, the SE-38 is capable of detecting the first edge of a web and then ignoring any and all subsequent variations. It has a standard sensing gap of 50.8 mm (2 inches) and a control range of 43.2 mm (1.7 inches) delivering precise, versatile control for single-edge or center guiding applications.



GENERAL SPECIFICATIONS

Part Number

SE-38 First*Edge Sensor

Sensor Resolution

1 pixel (0.063 mm / 0.0025 inch)

Light Source

880 to 990 nm infrared light

Detection Device

CMOS linear photodiode array

Update Rate

6 ms

Supply Voltage

+10 to 15 VDC

Supply Current

<80 mA (<55 mA average)

Output Signal

0 to 10 mA

Weight

856 grams (30 ounces)

Temperature Range:

0° to 60° C (32° to 140° F)

KEY FEATURES

- All-digital sensor eliminates effects of opacity variations in non-woven materials
- Unique 180° foldback prism detects materials that are nearly impossible to sense with infrared-only, air or ultrasound
- Immune to web plane changes and unaffected by ambient light, including sunlight
- Compatible with all Fife controllers
- Standard sensing gap of 50.8 mm (2.0 inches) with a control range of 43.18 mm (1.7 inches)
- Flexible mounting and positioning assemblies ensure quick and easy installation
- Electrostatic discharge protected

FIFE SE-38 FIRSTEDGE SENSOR

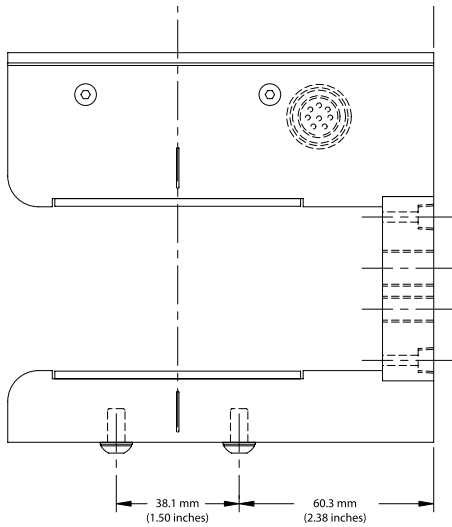

SE-38 SENSOR ASSEMBLY SHOWN WITHOUT OPTIONAL MOUNTING BRACKET

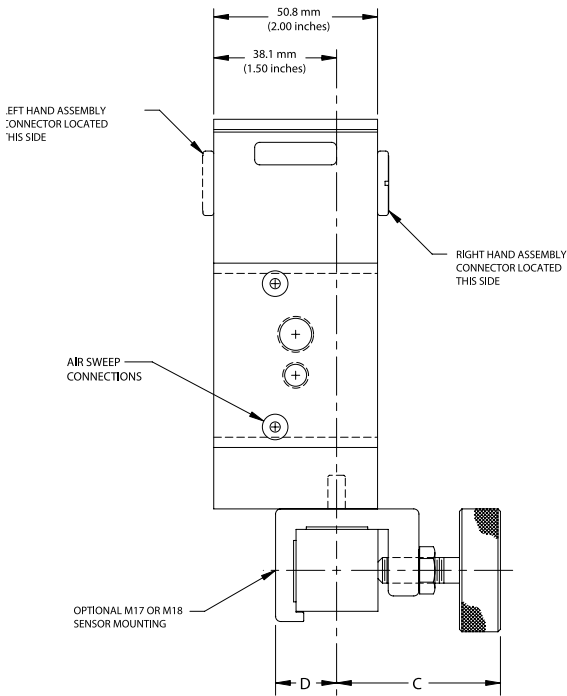
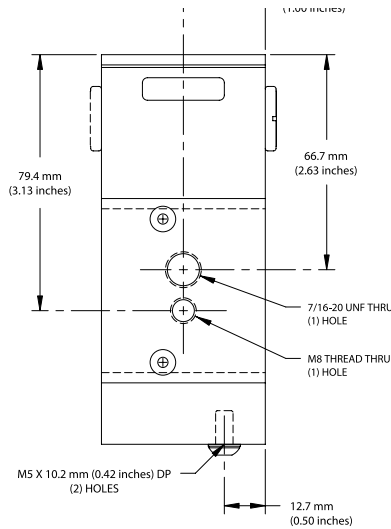

SE-38 SENSOR ASSEMBLY SHOWN WITH OPTIONAL M18 MOUNTING BRACKET

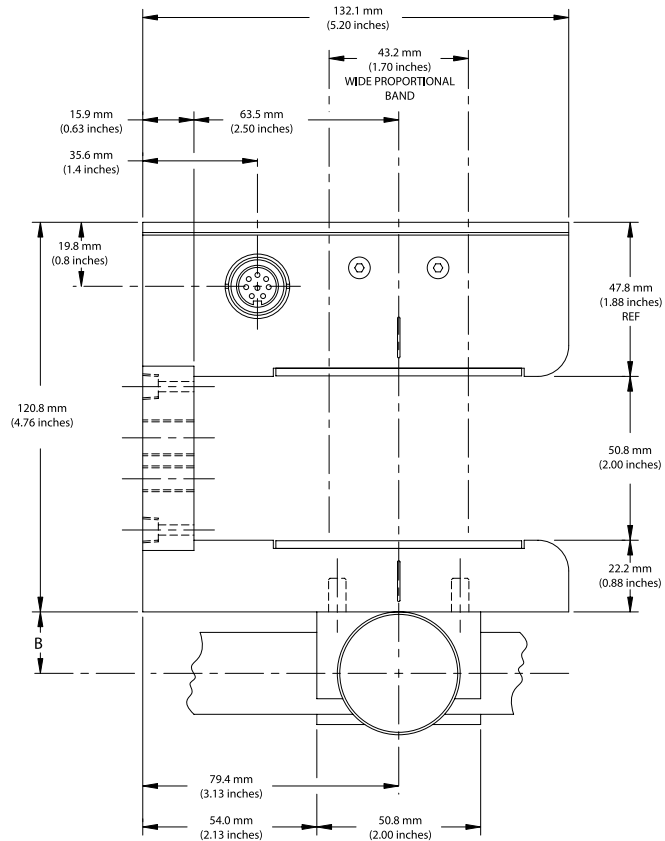

MAGPOWER



TIDLAND

NORTH AMERICA

Toll Free 800.636.3433
Tel +1.405.755.1600
Fax +1.405.755.8425
sales@maxcessintl.com
www.maxcessintl.com

SOUTH AMERICA

Tel +55.11.3959.0990
Fax +55.11.3856.0990
southamerica@maxcessintl.com
www.maxcessintl.com.br

EUROPE

Tel +49.6195.7002.0
Fax +49.6195.7002.933
sales@maxcess.eu
www.maxcess.eu

INDIA

Tel +91.22.27602633
Fax +91.22.27602634
india@maxcessintl.com
www.maxcess.in

CHINA

Tel +86.756.881.9398
Fax +86.756.881.9393
info@maxcessintl.com.cn
www.maxcessintl.com.cn

JAPAN

Tel +81.43.421.1622
Fax +81.43.421.2895
japan@maxcessintl.com
www.maxcess.jp

KOREA, TAIWAN AND SE ASIA

Tel +65.9620.3883
Fax +65.6235.4818
asia@maxcessintl.com