

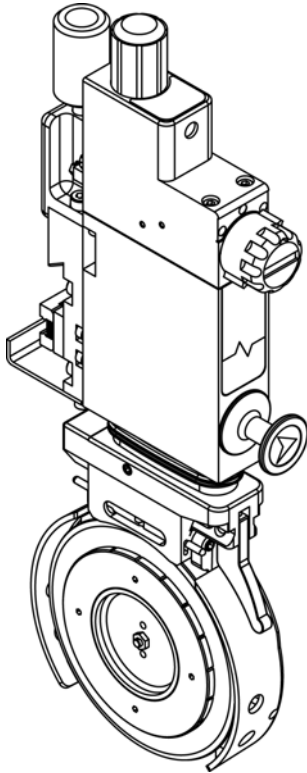

Tidland Performance Series Class I Knifeholder

Easy Glider Retrofit Instructions



Class 1 Knifeholder
Performance Series Automatic shown

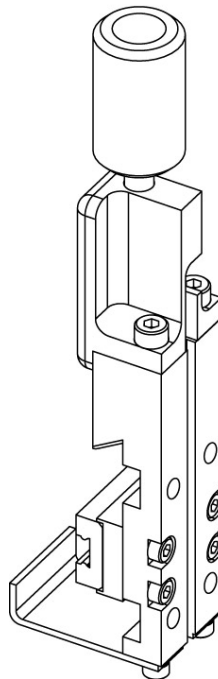

Manual Lock

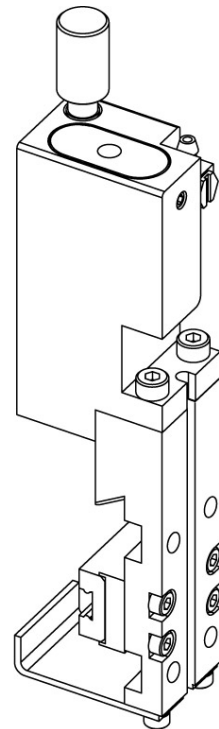

Pneumatic Lock

Easy Glider Assembly

SAFETY



- Sharp knives can cause serious injury.
- Tidland recommends wearing stainless steel protective gloves when changing or removing the knife blade.

- Compliance with federal, state, and local safety regulations is your responsibility. Be familiar with them and always work safely.

RECEIVING AND UNPACKING

- Handle and unpack the equipment carefully. Upon arrival, check the shipment against the packing list.
- Promptly report to the carrier any damaged equipment.
- Equipment that will not be installed immediately should be stored in a clean, dry location.
- Be careful to prevent moisture, dust, and dirt from accumulating in storage and installation areas.



IMPORTANT

- Do not remove the factory-installed short rail section from the linear bearing that is installed on your knifeholder mount.
- This rail section must be used to install the knifeholder onto the guide bar rail.

Failure to use this rail section when installing the knifeholder may result in bearing damage and void bearing warranty.

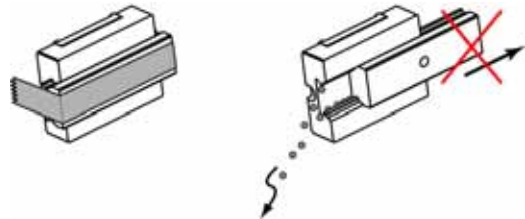

REQUIRED TOOLS

- 3 mm T-handle hex wrench.
- *Parker Super-O-Lube* o-ring lubricant
- 5/32" transfer punch
- #30 drill
- M4 tap

EASY GLIDER PARTS

The Tidland Class I *Easy Glider* mount is fully assembled at time of shipping and can be used with your existing guide bar locking mechanism.

You will need to install guide bar designed for linear bearings.

The instructions on the following pages apply to several Tidland knifeholder configurations: Performance Series Manual, Automatic and Crush with either the manual or pneumatic guide bar mount.

The Performance Series Automatic Knifeholder with a pneumatic locking mount is illustrated for the purpose of these instructions. Air fittings vary depending upon your knifeholder type.

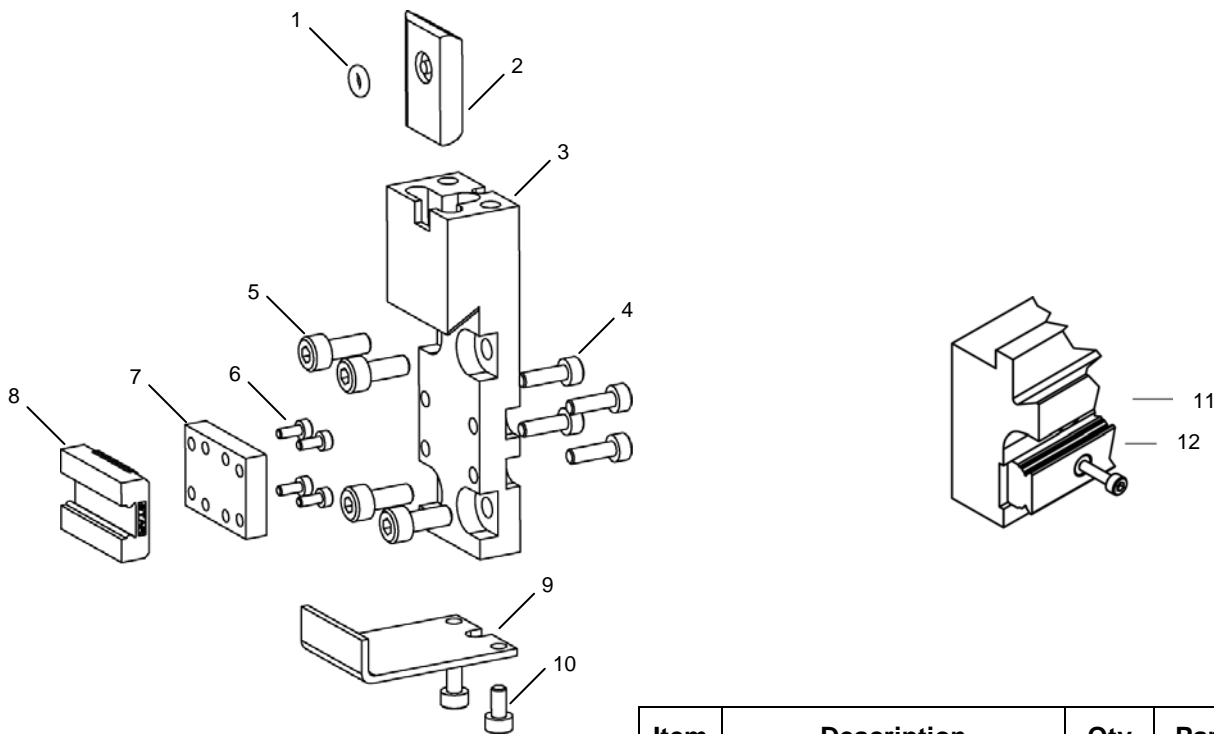

Item	Description	Qty	Part No.
	Back Plate Assembly		689497
1	O-ring	1	130136
2	Brake shoe	1	537972
3	Back plate	1	662078
4	Socket head cap screw	4	130163
5	Socket head cap screw	4	130184
6	Socket head cap screw	4	662169
7	Bearing spacer	1	662079
8	Linear bearing	1	662081
9	Safety	1	662080
10	Socket head cap screw	2	130247
11	Guide bar	a/r	661590
12	Linear bearing rail	a/r	662082

PREPARING THE KNIFEHOLDER



You will need to remove the knifeholder from the guide bar. (See the operating manual for your specific knifeholder type.)

1. Disconnect air supply hose at the manifold.
2. Remove knifeholder from guide bar.
3. Remove blade cartridge from control body.

Remove the top block from the back plate

1. Remove two socket head cap screws (3 mm hex drive).
2. Disconnect air hoses.
3. Lift the top block from the back plate.

This assembly will be used with the *Easy Glider* back plate.

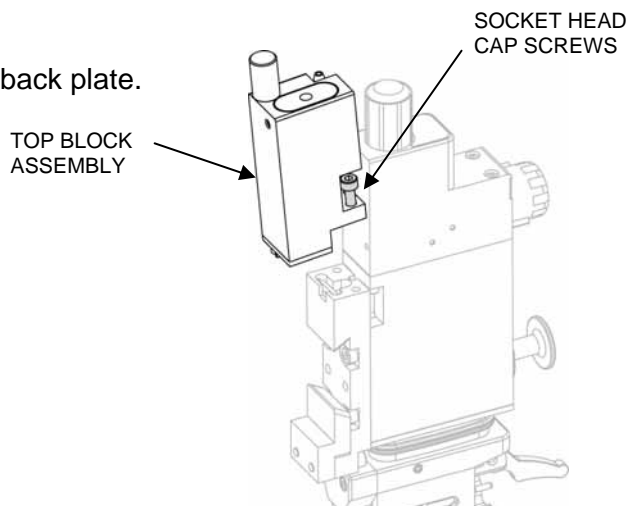

Remove existing back plate from the knifeholder

1. Remove gib by removing two socket head cap screws (3 mm hex drive).
2. Remove the back plate by removing four socket head cap screws (3 mm hex drive).

You will not need the gib with the *Easy Glider* mount.

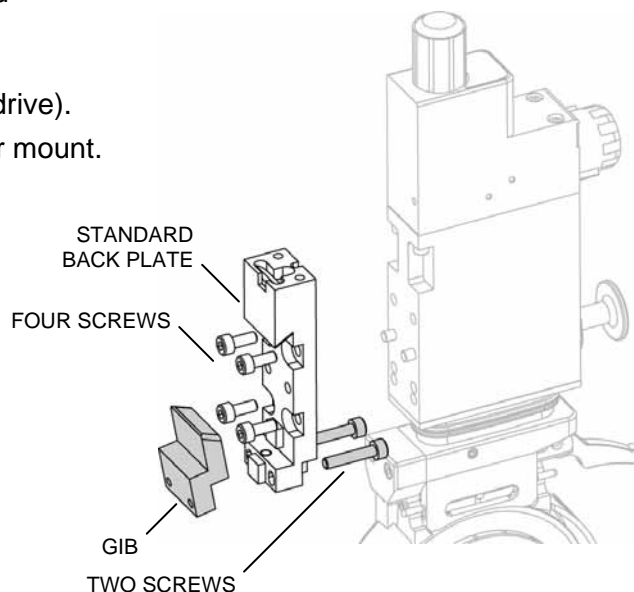

INSTALLING THE *EASY GLIDER* MOUNT

Grind alignment pins from control body

If you cannot pull the alignment pins out using a hand tool, use a grinding tool to grind them **flush** to the surface.



Do not grind into the control body surface.

ALIGNMENT PINS

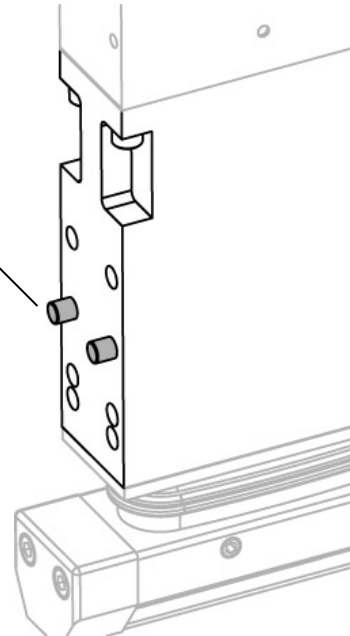

Add new hole locations for *Easy Glider* back plate

If your knifeholder does not have six mounting holes on the back of the control body you will need to add two mounting holes as indicated by the dimensions illustrated.

Use the *Easy Glider* back plate as a template to locate the two additional holes.

1. Install back plate with fasteners in top two holes on the back of the lower body assembly.
2. Mark new tapped hole locations using a 5/32" transfer punch.
3. Remove back plate.
4. Drill and tap new M4 holes
 - a) Drill #30 x 23/64" deep.
 - b) Tap M4 x 0.8 x 15/64" deep.



Do not exceed specified depth or damage to the knifeholder internal bushings may occur.

Note: Dimensions shown are for reference only.
Use transfer punch method described to locate holes.

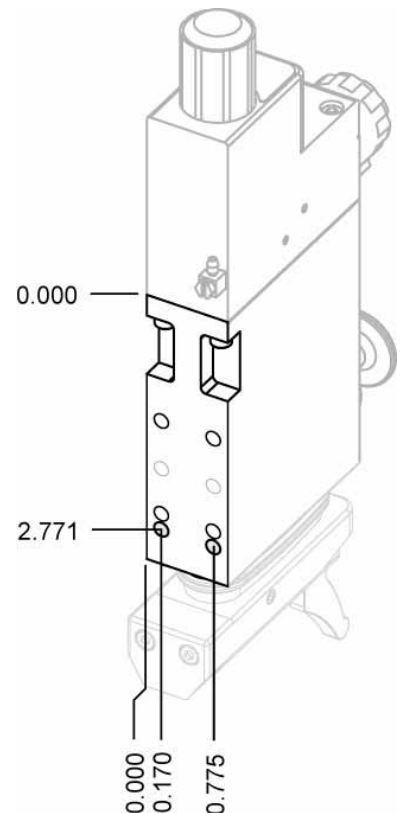

INSTALLING THE *EASY GLIDER* MOUNT

Reassemble the *Easy Glider* assembly

1. Reinstall the top block mount on the *Easy Glider* back plate.
2. Torque the screws to 2.1 ft·lbs.

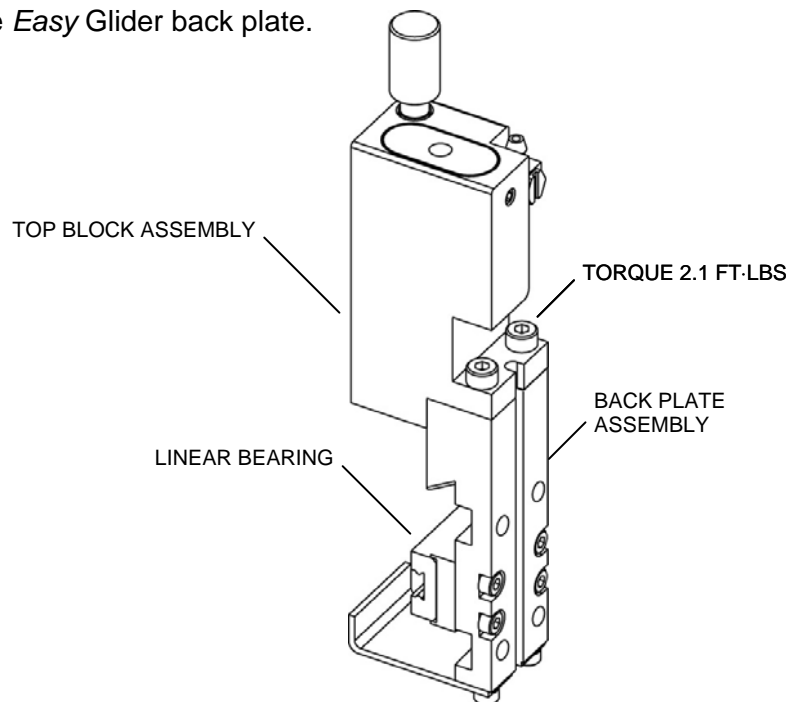

Install the *Easy Glider* back plate assembly

1. Secure the back plate assembly to the knifeholder body.
2. Torque the screws to 2.1ft·lbs.
3. Reinstall the blade cartridge
4. Reconnect the air lines.

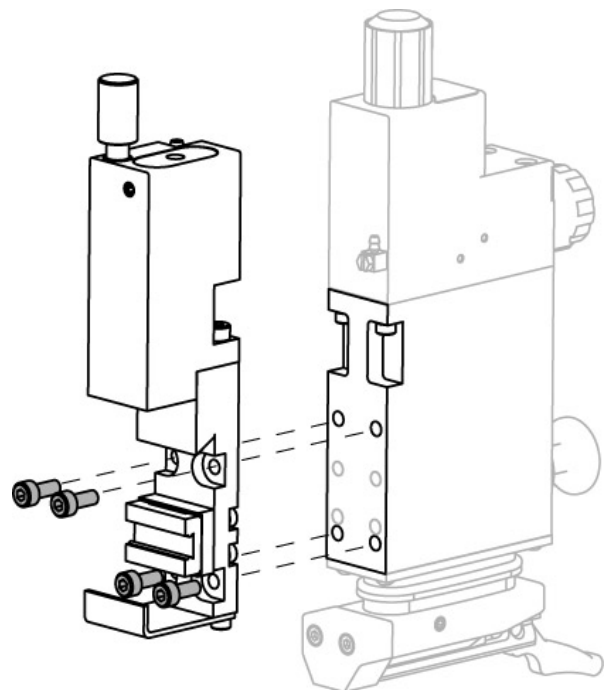

INSTALLING THE KNIFEHOLDER

Easy Glider Mount (Linear Bearing)



READ FIRST

- Do not remove the factory-installed short rail section from the linear bearing.
- This rail section must be used to install the knifeholder onto the guide bar rail.
- Failure to use this rail section when installing the knifeholder may result in bearing damage and **void bearing warranty**.

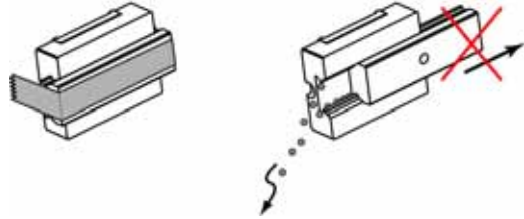

Safety Recommendation

Remove blade cartridge from knifeholder before handling.

1. Choose at which end of the guide bar the knifeholders will be mounted.
2. At the mounting end only, locate and remove the #10-32 end stop screw on the face of the guide bar.
3. Do not remove the short rail from the knifeholder bearing.
4. Make sure the knifeholder brake is unlocked.
5. Push the brake shoe up into the back plate if protruding.
6. Install the knifeholder:
 - a. Hold the knifeholder and short rail section together. Carefully place the rail section into the keyway on the guide bar.
 - b. Align the short rail section with the fixed bearing rail on the guide bar.
 - c. Slide the knifeholder onto fixed bearing rail.
7. Remove short section of bearing rail from the guide bar. **Note:** Keep the short rail for future maintenance and knifeholder removal.
8. Repeat Steps 4-7 until all knifeholders are installed on the guide bar.
9. After all knifeholders are installed, reinstall the #10-32 screw in the end stop.
10. Reinstall blade cartridges on knifeholders.
11. Turn the function control knob to RED (retract) position on all knifeholders.

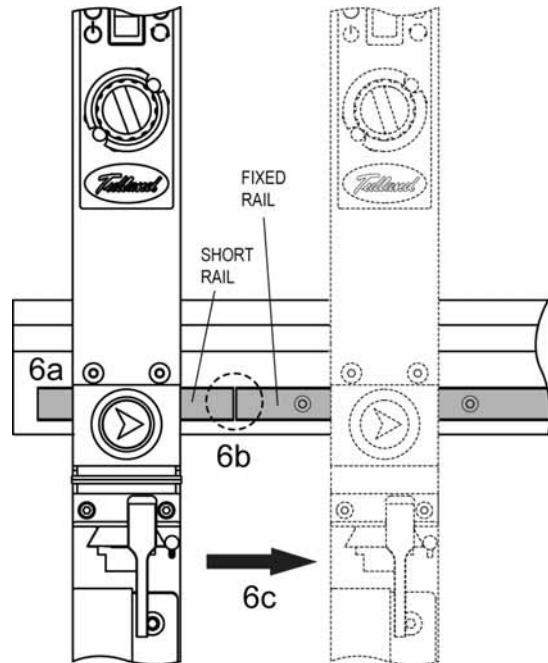

All rights reserved. No part of this publication may be reproduced, transmitted, transcribed, or translated into any language in any form by any means without the written permission of Tidland.



NORTH AMERICA

Toll Free 800.639.3433
Tel +1.405.755.1600
Fax +1.405.755.8425
sales@maxcessintl.com
www.maxcessintl.com

EUROPE

Tel +49.6195.7002.0
Fax +49.6195.7002.933
sales@maxcess.eu
www.maxcess.eu

CHINA

Tel +86.756.881.98398
Fax +86.756.881.9393
sales@maxcessintl.com.cn
www.maxcessintl.com.cn

**KOREA, TAIWAN,
AND SE ASIA**

Tel +65.9620.3883
Fax +65.6235.4818
asia@maxcessintl.com

SOUTH AMERICA

Tel +55.11.3959.0990
Fax +55.11.3856.0990
southamerica@maxcessintl.com
www.maxcessintl.com.br

INDIA

Tel +91.22.27602633
Fax +91.22.27602634
india@maxcessintl.com
www.maxcess.in

JAPAN

Tel +81.43.421.1622
Fax +81.43.421.2895
japan@maxcessintl.com
www.maxcess.jp

© 2011 Maxcess