



Air shafts cannot be inserted into rolls with even with the slightest deformation, leaving damaged rolls useless. Standard models re-open 70 mm (2-3/4 inch) to 76 mm (3 inch) ID cores without any special training. The Roll Saver provides a return on your investment with its first use as the cost is comparable to that of a damaged roll, creating a positive impact on profit margins and warehouse space.



The Mark I Roll Saver (in photo, top) can be used to reopen crushed cores up to 1.8 m (70 inches) in diameter. Multi-core size adapters are also available for 102, 127, and 152 mm (4, 5, and 6 inch) ID cores, which are capable of repairing rolls up to 3.56 m (140 inches) in diameter.

At less than 20 pounds, the lightweight Mark II Roll Saver (in photo, bottom) is fully portable and easily re-opens crushed cores up to 1,143 mm (45 inches) in diameter.

GENERAL SPECIFICATIONS

	MARK I ROLL SAVER		MARK II ROLL SAVER	
	70 mm to 76 mm	2-3/4 inches to 3 inches	70 mm to 76 mm	2-3/4 inches to 3 inches
Core ID	70 mm to 76 mm	2-3/4 inches to 3 inches	70 mm to 76 mm	2-3/4 inches to 3 inches
Penetration	915 mm	36 inches	250 mm	10 inches
Weight (body only)	17 kg	37 lbs	N/A	N/A
Weight (with pump)	26 kg	57 lbs	9 kg	19 lbs
Hydraulic Pressure	700 bar	10,150 psi	621 bar	9,000 psi
For Roll Diameters up to	1.8 m	70 inches	1,025 mm diameter, 902 mm width	45 inch diameter, 36 inch width
Expansion	Approximately 1/4 inch above nominal core			

KEY FEATURES

- Two models deliver up to 700 bar (10,150 psi) to re-open even the most damaged cores up to 1.8 m (70 inches) in diameter
- Standard models fit 70 mm (2-3/4 inch) to 76 mm (3 inch) cores
- Adapters available (Mark I only) for 102, 127, and 152 mm (4, 5, and 6 inch) ID cores
- Return on investment can be achieved with first salvaged roll
- Durable construction for reliable, long-lasting operation
- Lightweight, easy to use design provides fast results without any special training

TIDLAND ROLL SAVERS

DESIGN FEATURES

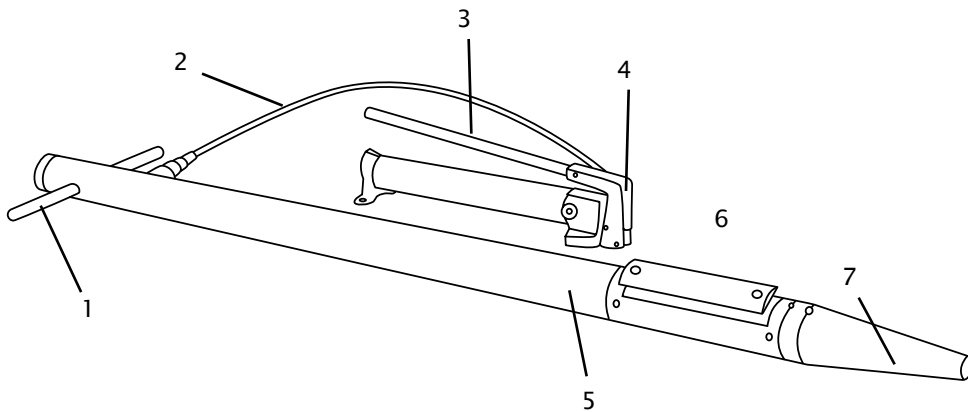

MARK I ROLL SAVER

1. Roll Saver Handle
2. Hydraulic Hose
3. Pump Handle
4. Hydraulic Pump
5. Body
6. Pressure Plate (Expanding Leaf)
7. Nose Piece

MARK II ROLL SAVER

1. Roll Saver Handle
2. Relief Valve
3. Cast Steel Jaws
4. Base Plate
5. Hydraulic Connector
6. Hydraulic Pump

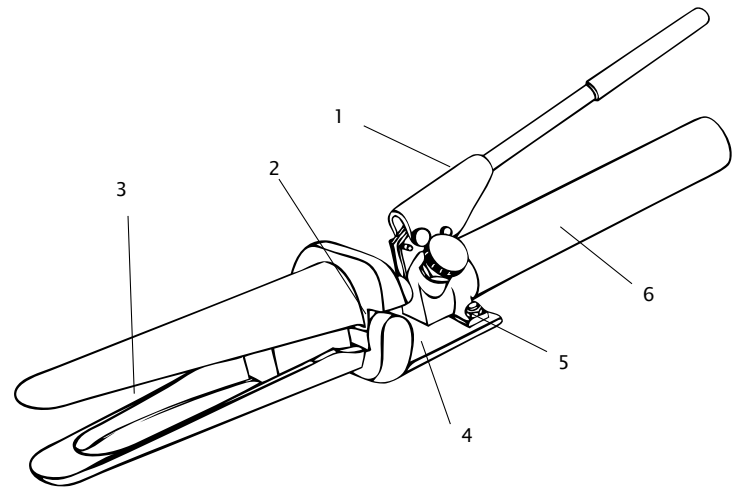

The Mark I Roll Saver is inserted with the pressure plate against the core crush area.

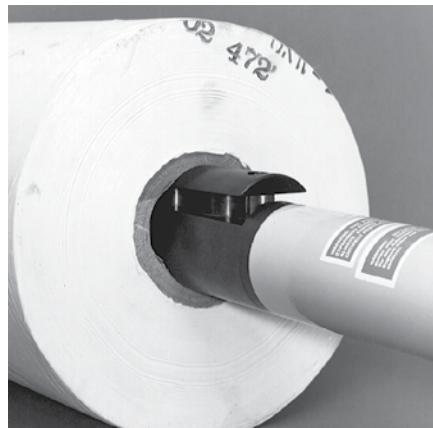

The hydraulic pump is operated to manually recondition the core.

OPTIONS

Mark I Roll Saver: A choice for optional adapters is available for the following ID cores:

- 102 mm (4 inches) - 5 kg (10 lbs) P/N 700026
- 127 mm (5 inches) - 8 kg (18 lbs) P/N 700034
- 152 mm (6 inches) - 13 kg (29 lbs) P/N 129871

All Roll Saver Models: Optional Sledge for Insertion
Sledge weight - 9 kg (20 lbs) P/N 133144

MAXCESS



NORTH AMERICA

Toll Free 800.426.1000
Tel +1.360.834.2345
Fax +1.360.834.5865
sales@maxcessintl.com
www.maxcessintl.com

EUROPE

Tel +49.6195.7002.0
Fax +49.6195.7002.933
sales@maxcess.eu
www.maxcess.eu

CHINA

Tel +86.756.881.9398
Fax +86.756.881.9393
info@maxcessintl.com.cn
www.maxcessintl.com.cn

KOREA, TAIWAN AND SE ASIA

Tel +65.9620.3883
Fax +65.6235.4818
asia@maxcessintl.com

SOUTH AMERICA

Tel +55.11.3959.0990
Fax +55.11.3856.0990
southamerica@maxcessintl.com
www.maxcessintl.com.br

INDIA

Tel +91.22.27602633
Fax +91.22.27602634
india@maxcessintl.com
www.maxcess.in

JAPAN

Tel +81.43.421.1622
Fax +81.43.421.2895
japan@maxcessintl.com
www.maxcess.jp