



The Tidland G690 is a narrow to medium web width core shaft designed for the global converting markets. It features a unique external bladder to activate four expanding leaves to grip the core and not deform it. The air system features a proven robust design and is easy to maintain. Since the G690 is manufactured in North and South America, Europe and China, it is easily sourced and supported worldwide. All components conform to Tidland's high quality standards and are interchangeable regardless of where the shaft is installed.

GENERAL SPECIFICATIONS

Web Width		Max Roll Wt - Cantilevered			Torque Capacity		Max Tension at 1000mm Ø	
			Alum	Alloy				
mm	305	kg	398	682	N-M	54	kg/cm	0,4
in	12	Lbs	875	1500	in-lbs	480	PLI	2
mm	381	kg	327	682	N-M	68	kg/cm	0,4
in	15	Lbs	720	1500	in-lbs	600	PLI	2
mm	508	kg	252	682	N-M	90	kg/cm	0,4
in	20	Lbs	555	1500	in-lbs	800	PLI	2
mm	635	kg	202	500	N-M	113	kg/cm	0,4
in	25	Lbs	445	1100	in-lbs	1000	PLI	2
mm	762	kg	159	500	N-M	136	kg/cm	0,4
in	30	Lbs	350	1100	in-lbs	1200	PLI	2
mm	1016	kg		364	N-M	181	kg/cm	0,4
in	40	Lbs		800	in-lbs	1600	PLI	2
mm	1270	kg		364	N-M	226	kg/cm	0,4
in	50	Lbs		800	in-lbs	2000	PLI	2

KEY FEATURES

- Four expanding leaves provide 360 degree support to your core.
- Compact design
- Standard extruded body design
- Standard component parts
- Manufactured in North and South America, Europe, and China
- Light weight aluminum extrusion body
- High Torque, serrated expanding leaves

DESIGN FEATURES

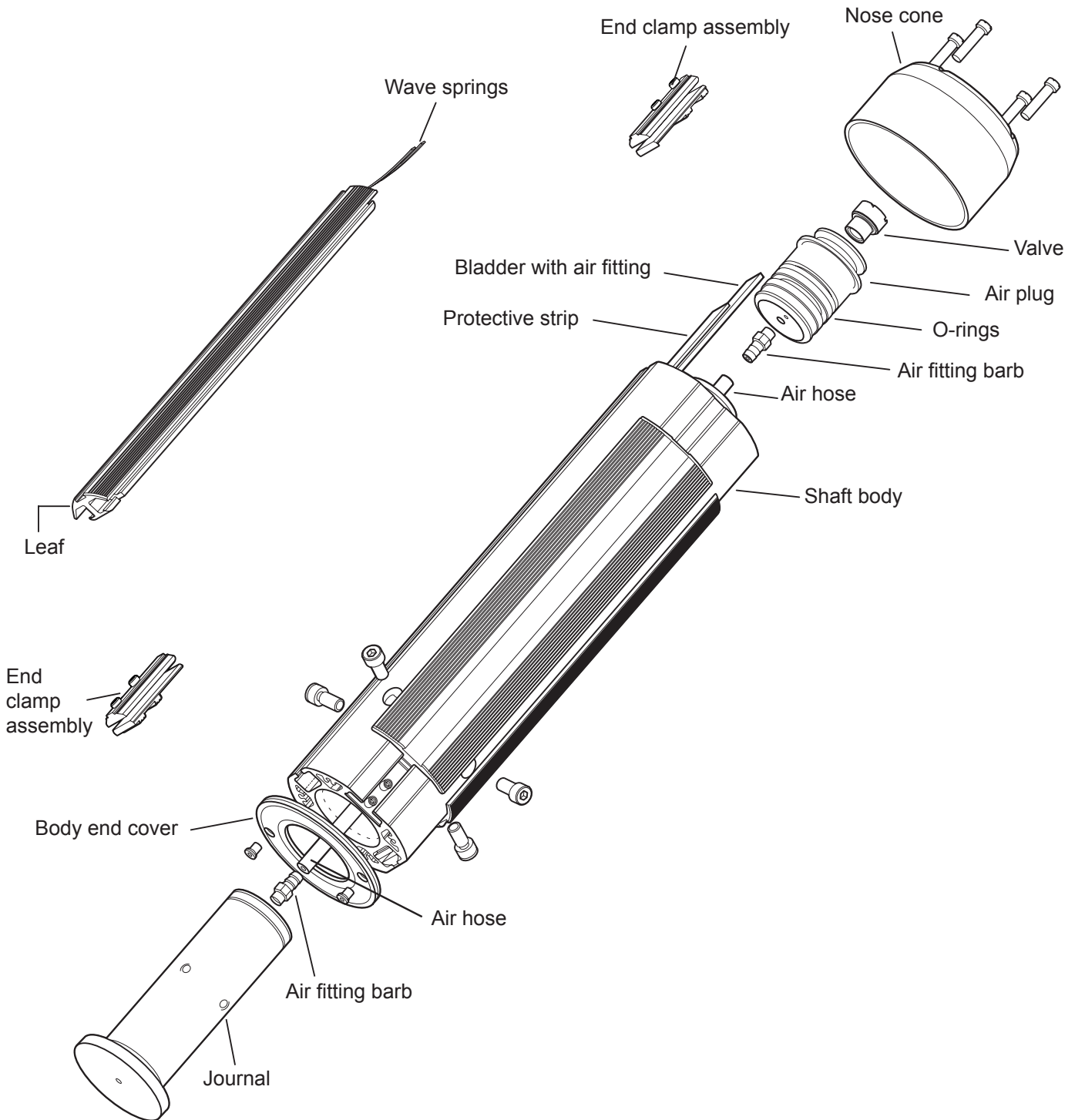

MAXCESS

MAGPOWR

FIFE

TIDLAND

NORTH AMERICA

Toll Free 800.426.1000
 Tel +1.360.834.2345
 Fax +1.360.834.5865
 sales@maxcessintl.com
 www.maxcessintl.com

EUROPE

Tel +49.6195.7002.0
 Fax +49.6195.7002.933
 sales@maxcess.eu
 www.maxcess.eu

CHINA

Tel +86.756.881.9398
 Fax +86.756.881.9393
 info@maxcessintl.com.cn
 www.maxcessintl.com.cn

KOREA, TAIWAN AND SE ASIA

Tel +65.9620.3883
 Fax +65.6235.4818
 asia@maxcessintl.com

SOUTH AMERICA

Tel +55.11.3959.0990
 Fax +55.11.3856.0990
 southamerica@maxcessintl.com
 www.maxcessintl.com.br

INDIA

Tel +91.22.27602633
 Fax +91.22.27602634
 india@maxcessintl.com
 www.maxcess.in

JAPAN

Tel +81.43.421.1622
 Fax +81.43.421.2895
 japan@maxcessintl.com
 www.maxcess.jp