



BEST QUALITY WITH NARROW SLITS

The Tidland W19 knifeholder combines all the advantages of the Tidland swing cartridge with a rigid and robust design, achieving a minimum slit width of only 19mm, while delivering best slit quality and extended blade life.

The Tidland W19 knifeholder also features a reference finger for quick and precise adjustment of the knifeholder position relative to the anvil blade.

No tools are required to remove the quick release blade cartridge from the knifeholder body. When performing this operation, the blade is easily removed from the front of the knifeholder without the need for any space at the sides. This allows the knifeholder to remain in its slitting position on the guide bar when replacing the blade.

This unique feature of the Tidland W19 significantly reduces the system downtime, since the knifeholder is immediately ready to work as no repositioning is required after the blade change.



GENERAL SPECIFICATIONS

Blade Diameter	Down stroke (Cartridge)
105 mm	18 mm
Minimum Slit Width	Maximum Slitting Speed
19 mm	1600 m / min
Side shift (Blade)	Recommended Air Pressure
1,8 mm	3 – 6 bar

KEY FEATURES

- Robust double-rod construction to withstand harsh industrial environments
- Integrated Reference finger for precise blade position setting
- Uses 180° reversible blade cartridge, allowing use of both sides of the anvil ring, extending blade life
- No tools required for blade cartridge removal
- Fully compatible with Tidland C1 knifeholders and dovetail guide bar
- 360° mechanical blade guard available as option

TIDLAND MODEL W19

ULTRA-NARROW SHEAR SLITTING KNIFEHOLDER

W19 DIMENSIONS

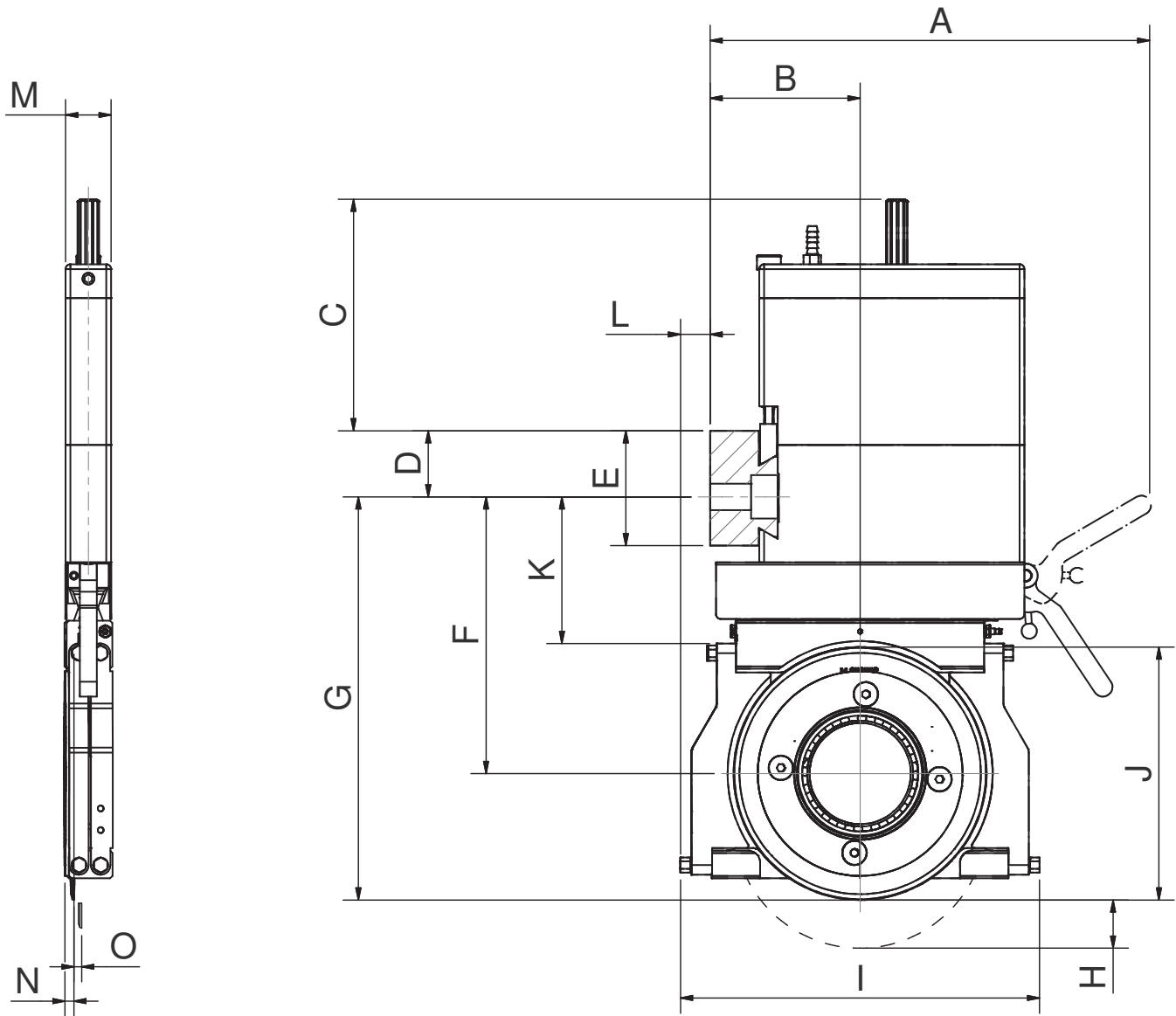

SIZE	WEB PATH	A	B	C	D	E	F	G	H	I	J	K	L	M	N	O
mm	A	192	61,7	96	27,4	48	115	167,4	18	149	105	61	12,5	19	3,7	1,8
	B		67,9													

MAXCESS

MAGPOWER



TIDLAND

EUROPE, MIDDLE EAST AND AFRICA

Tel +49.6195.7002.0
 Fax +49.6195.7002.933
 sales@maxcess.eu
 www.maxcess.eu

INDIA

Tel +91.22.27602633
 Fax +91.22.27602634
 india@maxcessintl.com
 www.maxcess.in

NORTH, CENTRAL AND SOUTH AMERICA

Tel +1.405.755.1600
 Fax +1.405.755.8425
 sales@maxcessintl.com
 www.maxcessintl.com

JAPAN

Tel +81.43.421.1622
 Fax +81.43.421.2895
 japan@maxcessintl.com
 www.maxcess.jp

CHINA

Tel +86.756.881.9398
 Fax +86.756.881.9393
 info@maxcessintl.com.cn
 www.maxcessintl.com.cn

KOREA, TAIWAN AND SE ASIA

Tel +65.9620.3883
 Fax +65.6235.4818
 asia@maxcessintl.com