



CONTROL SERIES ELECTRONIC KNIFEHOLDER

CLASS I,II,III

A MAXCESS[®] BRAND

Maximize operator safety, productivity and roll quality with Tidland's newest innovation in slitting. Featuring an LED-backlit touchscreen interface on Class II and III sizes, an OLED display with keypad on Class I, and electronic control with auto-calibration, the Control Series offers a dramatic improvement in knifeholder technology.

Available in two models, Control and Control Plus, both offer auto-calibration of side force and blade overlap to allow accurate setup in seconds without operator intervention, resulting in increased consistency, less blade wear and reduced downtime between runs.

The Control Plus model adds closed-loop side force control, real-time monitoring via the onboard touchscreen or external PC interface, and available wireless operation so that settings and can be confirmed and consistently maintained.



GENERAL SPECIFICATIONS

*Dependent on material and application.

	CLASS I	CLASS II	CLASS III
	NARROW	STANDARD	MILL-DUTY
Minimum Slit Width	25.4 mm (1 inch)	50.8 mm (2 inches)	76.2 mm (3 inches)
Maximum Designated Speed*	1,000 mpm (3,500 fpm)	1,676 mpm (5500 fpm)	3,000 mpm (10,000 fpm)
Electrical Requirement	24 VDC	24 VDC	24 VDC
Blade Diameter	90 mm (3.54 inches)	150 mm (5.91 inches)	200 mm (7.87 inches)
Auto-Calibrate Accuracy	+/- 0.113 kg (0.25 lb) side force +/- 0.013mm (0.0005 inch) down stroke	+/- 0.226 kg (0.5 lb) side force +/- 0.076 mm (0.003 inch) down stroke	

KEY FEATURES

- Minimized operator intervention results in a safer slitting operation
- Lower operating costs due to reduced scrap and increased blade life
- Auto-calibration reduces the potential for operator error
- Consistent, high quality slits
- LED-backlit touchscreen or keypad enables easy programming and monitoring, even with gloves on
- Reduced setup times with auto-calibration
- Available wireless operation from any Wi-Fi enabled device
- Control Plus adds closed-loop side force control and real-time monitoring via the onboard touchscreen or external PC interface

NOMENCLATURE AND DIMENSIONS

CLASS I, II & III

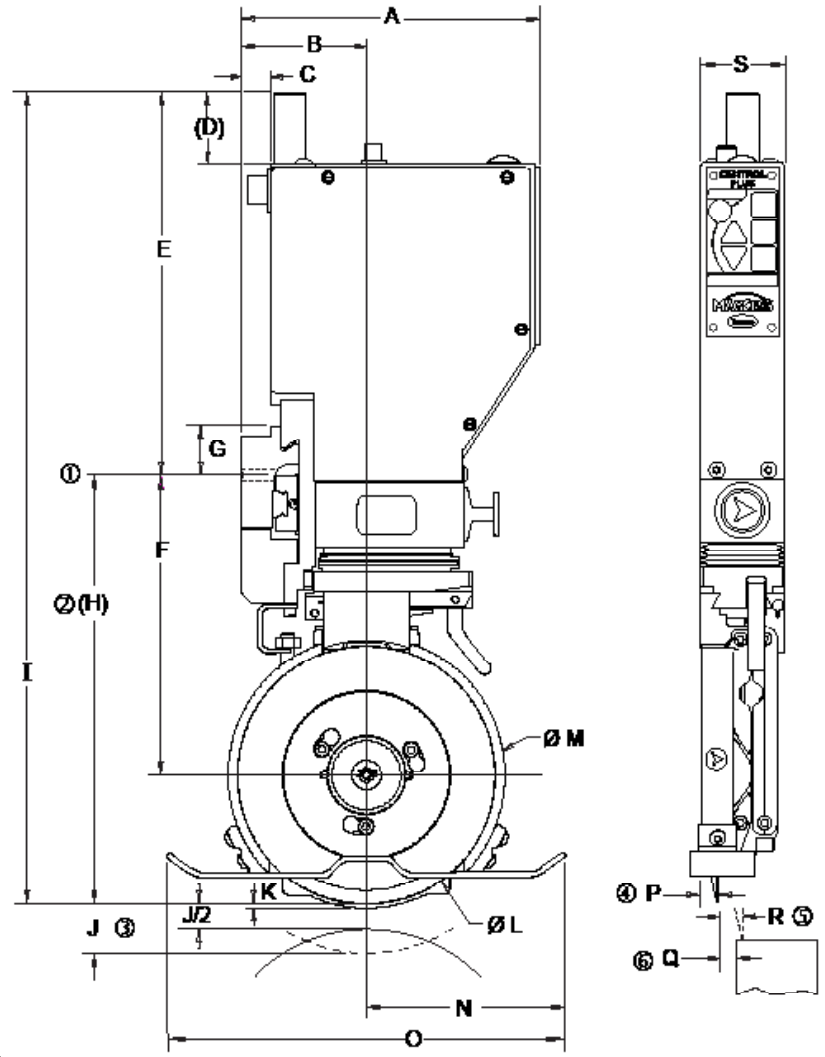
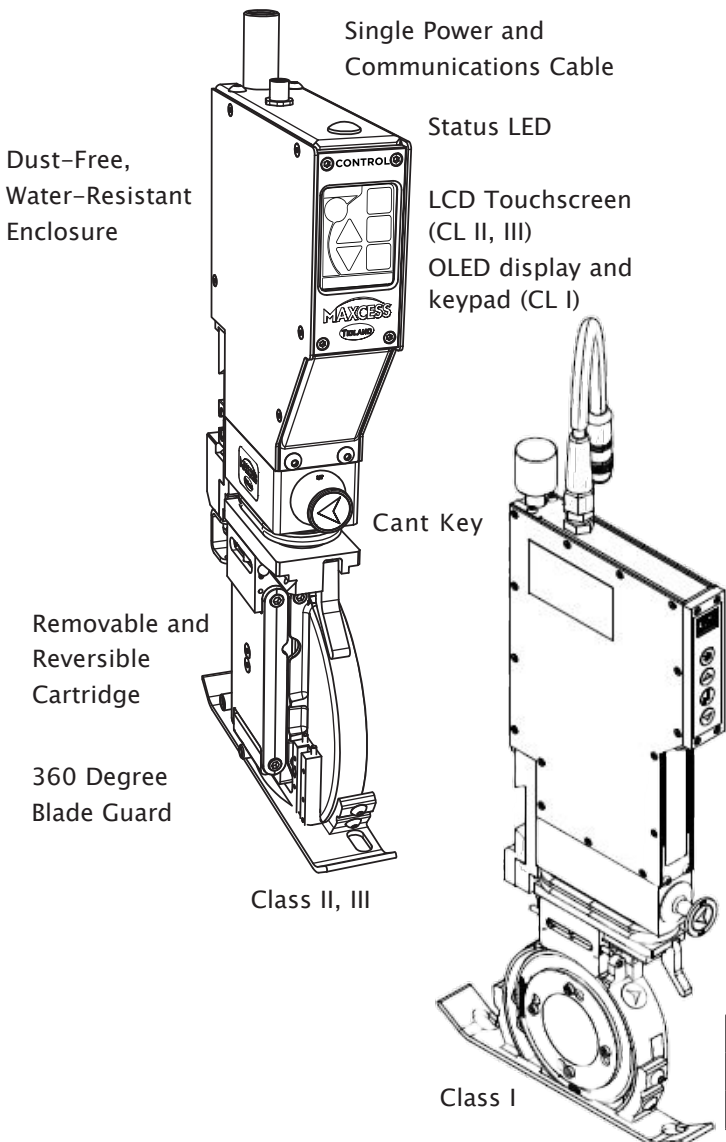

1	Center of guide bar mounting holes	4	Blade position when retracted
2	When knifeholder is retracted	5	Full stroke
3	Maximum vertical stroke	6	Half stroke

CLASS I CONTROL SERIES ELECTRONIC KNIFEHOLDER

	A	B	C	D	E	F	G	H	I	J	K	L	M	N	O	P	Q	R	S
inches	6.04	2.46	0.69	1.33	9.02	4.85	1.04	6.62	15.65	0.63		3.54	3.92	3.62	7.24	0.20	0.08	0.16	0.98
mm	153.3	62.6	17.4	33.7	229.2	123.2	26.4	168.2	397.4	16		90	99.64	92	184	5.02	2	4	25

CLASS II CONTROL SERIES ELECTRONIC KNIFEHOLDER

	A	B	C	D	E	F	G	H	I	J	K	L	M	N	O	P	Q	R	S
inches	7.03	2.94	0.74	1.75	8.78	6.81	1.23	9.76	18.54	.965	0.09	5.91	6.33	4.56	9.12	0.49	0.07	0.20	1.94
mm	178.6	74.7	18.8	44.4	223.0	173.0	31.2	247.9	470.9	24.5	2.4	150.1	160.8	115.8	231.6	12.4	1.8	5.1	49.3

CLASS III CONTROL SERIES ELECTRONIC KNIFEHOLDER

	A	B	C	D	E	F	G	H	I	J	K	L	M	N	O	P	Q	R	S
inches	7.46	3.45	0.61	0.74	6.76	7.74	1.23	11.68	18.43	1.00	0.15	7.87	8.35	5.02	10.05	0.65	0.12	0.33	2.91
mm	189.5	87.6	15.5	18.8	171.7	196.6	31.2	296.7	468.1	25.4	3.8	199.9	212.1	127.5	255.3	16.5	3.0	8.4	73.9

AMERICAS
Tel +1.405.755.1600
Fax +1.405.755.8425
sales@maxcessintl.com
www.maxcess.com

EUROPE, MIDDLE EAST AND AFRICA
Tel +49.6195.7002.0
Fax +49.6195.7002.933
sales@maxcess.eu
www.maxcess.com

CHINA
Tel +86.756.881.9398
Fax +86.756.881.9393
info@maxcessintl.com.cn
www.maxcess.com

INDIA
Tel +91.22.27602633
Fax +91.22.27602634
india@maxcessintl.com
www.maxcess.com

JAPAN
Tel +81.43.421.1622
Fax +81.43.421.2895
japan@maxcessintl.com
www.maxcess.com

KOREA, TAIWAN AND SE ASIA
asia@maxcessintl.com
www.maxcess.com

